



# MAL?? 37

Year 2011

 **DIAMOND**

DIAMOND Yachts, Yachtzentrum Baltic Bay  
Börn 17 | 24235 Laboe

# MALÖ 37

**SOLD**
**239.000,00 €**

EU-VAT paid

## Main Info

<b>Model</b>	Malö 37
<b>Manufacturer</b>	Malö Yachts AB (SWE)
<b>Designer</b>	Leif Ångermark
<b>Category</b>	Cruiser
<b>Year</b>	2011
<b>Location</b>	Deutsche Ostseeküste
<b>Flag</b>	Germany
<b>VAT status</b>	EU-VAT paid
<b>Material</b>	GRP
<b>Rig</b>	Sloop with furling mast
<b>Cabins</b>	2
<b>Berths</b>	4

## Dimensions & Material

<b>LOA</b>	11.55 m
<b>LWL</b>	9.94 m
<b>Beam</b>	3.62 m
<b>Draft</b>	1.80 m
<b>Displacement</b>	9 t
<b>Sail area</b>	68 m <sup>2</sup>
<b>Engine</b>	YANMAR 3JH5E
<b>Power</b>	39 PS/29 KW
<b>Drive</b>	Shaft with folding propeller
<b>Fresh water</b>	400 L
<b>Fuel</b>	245 L
<b>Holding tank</b>	70 L

## Key Facts

- Stainless steel bow and stern anchors.
- Beautiful, traditional interior.
- Targa arch for mainsheet.
- Furling mast.
- Excellent condition.
- Full teak decks.
- Bow thruster.
- Shaft drive.

## Description

Safe and easily handling cruiser built by Malö Yachts AB on the traditional boatbuilder's island of Orust in the west swedish archipelago. Known for their exceptional craftsmanship, Malö yachts are highly regarded, especially in the Baltic region, thanks to their robust GRP construction, meticulously finished Scandinavian mahogany interiors, and top-quality technical installations. The strongback with laminated floors and stringers, the additionally bolted hull-deck joint, and laminated bulkheads provide a rigid, torsion-resistant structure. A solid lead keel, skeg-hung rudder, and low-maintenance shaft drive ensure excellent seaworthiness and reliability. A distinctive feature is the innovative GRP targa arch, which removes the mainsheet and traveler from the cockpit while also accomodating sprayhood and cockpit enclosure. All halyards, sheets, and control lines are led aft to the helm station for easy short handed sailing. The Malö 37 is the smallest model of the yard's final production series, offering impressive comfort for long-distance cruising or extended stays aboard while remaining easy and safe to manage with a small crew. This Malö 37, featuring the negative stern and integrated swim platform, is now available for sale. A well-maintained owner's yacht, built in 2011, equipped with furling mast, bow thruster, and full teak decks. The specification features an electric anchor windlass with stainless steel anchor at both bow and stern, as well as a ...

## Rig/Sails

- Deck-stepped, 9/10 fractional furling mast by SELDEN
- Two sets of aft-swept spreaders
- Manual backstay tensioner
- Fixed SELDEN kicker
- FURLEX genoa furling system
- Long genoa tracks with line-adjustable sheeting points
- Aluminium protection for rigging screws
- Furling mainsail Lundh-Sails Vertech with vertical battens approx. 36 m<sup>2</sup> (new 2021)
- Furling genoa Lundh-Sails Vertech approx. 40 m<sup>2</sup> (new 2021) with UV-protection

## Deck

- Teak on running decks, coachhouse roof, and in cockpit
- Scandinavian bowsprit in teak and stainless steel with retractable bow ladder
- Electric anchor windlass LOFRANS 1.000 W
- Mooring gear: stainless steel BRUCE anchor 20 kg with 70 m galvanized anchor chain 8 mm
- Folding stern anchor bracket with electric windlass and stainless steel BRUCE anchor 15 kg
- Primary winches ANDERSEN 46.2ST
- Secondary winches ANDERSEN 28.2ST
- Steering pedestal with instrument console
- Folding teak cockpit table
- Large cockpit locker to starboard
- GRP targa arch over cockpit with mainsheet traveler
- Fixed windscreen
- Sprayhood (new 2021) connecting windscreen and targa arch
- Cockpit cover (new 2021) attaching to targa arch covering entire cockpit
- Large mooring cleats and spring cleats midships
- Stainless steel bow protection rail
- Integrated "Gin [&] Tonic" seats in pushpit
- Cockpit shower hot/cold
- Swim ladder
- Teak outboard bracket on pushpit
- Strong, laminated rubbing strake with metal profile on hull sides



## Layout/Interior

- Beautiful, cozy saloon with U-shaped dinette around saloon table to port
- Optional saloon layout with two individual armchairs with cabinet in between to starboard
- Forward-facing helm station with navigator's seat, instrument panel, and switchboard to starboard aft
- L-shaped galley to port aft
  - Stainless steel double sink
  - Gas stove (2 burners and oven)
  - Large water-cooled refrigerator
  - Storage in drawers, lockers, and compartments
- Owner's cabin forward with double berth, lockers, shelves, and deck hatch
- Aft cabin to port with double berth, locker, shelves, and two portholes
- Heads compartment to starboard aft with sink, shower and electric toilet
- High-quality, finely crafted mahogany interior with eight layers of satin varnish in best Scandinavian boatbuilder's tradition, with teak floorboards
- Carpet throughout the yacht

## Technical Equipment

- YANMAR 3JH5E 3-cylinder inboard diesel 39 hp/29 kW
- Engine hours (as of January 2025): 384 h
- Shaft drive with flexible coupling and 3-blade folding propeller Flex-o-Fold
- Rope cutter on propeller shaft
- Stainless steel diesel tank approx. 245 l
- Tunnel bow thruster SIDEPOWER SE80/185T
- 230 V shore power connection with charging cable
- Battery charger 12 V
- Two AGM service batteries 12 V/115 Ah (new 2019)
- AGM starter battery 12 V/75 Ah (new 2019)
- Solar panel 80 Wp on sliding hatch garage
- Diesel heating EBERSPÄCHER 4 kW
- Hot water boiler ISOTEMP 25 l
- Electric toilet with stainless steel holding tank approx. 70 l with deck connection and sea discharge
- Safe

## Navigation/Electronics

- 3 x RAYMARINE ST70 instrument display with transducers for log, echo sounder and wind
- 12" GPS/chartplotter RAYMARINE Axiom 12+ (new 2020)
- AIS Class B-transponder RAYMARINE AIS700 (new 2019)
- Autopilot RAYMARINE with ST70 control unit
- Compass
- VHF-radio RAYMARINE Ray55E
- Radio/USB/DVD-player with two speakers in saloon and two FUSION cockpit speakers
- Flat-screen TV on electric lift in saloon to port
- Clock and barometer

### Safety

- Electric and manual bilge pump
- Fire extinguisher

### Accessories

- Full winter cover
- Fenders
- Pots [&] pans, crockery and cutlery
- Mooring lines

#### Brokerage Liability Disclaimer

All information especially regarding the VAT-status of a yacht has been supplied by third parties. It is non-binding and without guarantee, subject to error and alteration. Our brokerage relies exclusively on information supplied by the vendor carefully compiled and checked by us to the best of our knowledge. Hence, a liability for correctness and completeness of provided information cannot be assumed.

## IMAGES





## IMAGES

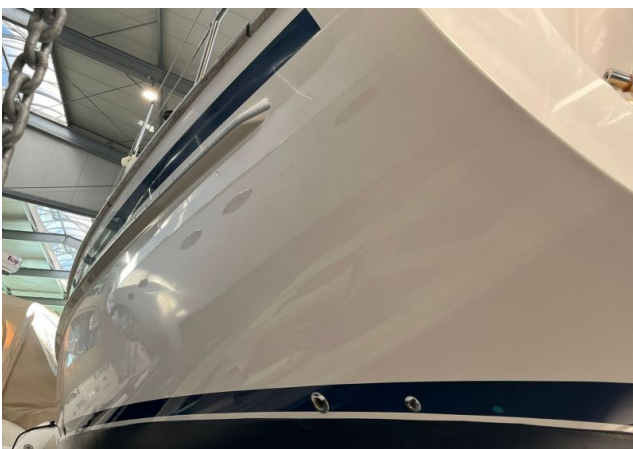



## IMAGES

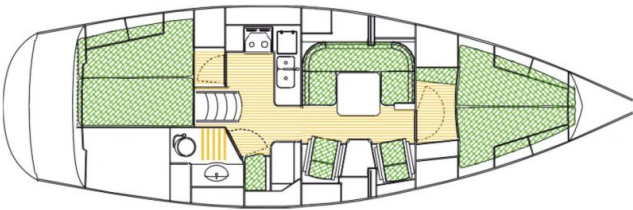



## IMAGES





## IMAGES





## IMAGES

