



HALLBERG-RASSY 42F MK II

Year 1996



DIAMOND

DIAMOND Yachts, Yachtzentrum Baltic Bay
Börn 17 | 24235 Laboe

HALLBERG-RASSY 42F MK II



Main Info

Model	Hallberg-Rassy 42F MK II
Manufacturer	Hallberg-Rassy Varvs AB
Designer	Germán Frers
Category	Centercockpit cruiser
Year	1996
Location	Deutsche Ostseeküste
Flag	Germany
VAT status	EU-VAT paid
Material	GRP
Rig	Sloop with cutter stay
Cabins	2
Berths	6

Dimensions & Material

LOA	13.22 m
LWL	10.49 m
Beam	3.95 m
Draft	2.00 m
Displacement	13 t
Sail area	89 m ²
Engine	VOLVO PENTA TMD22
Power	76 PS/56 KW
Drive	Shaft with MAXPROP
Fresh water	685 L
Fuel	420 L
Holding tank	120 L

Key Facts

- HR-42 Frers MK II with swim platform.
- Owner's cabin with two single berths.
- Very well maintained.
- Bow thruster.
- Beautifully crafted mahogany interior.
- Electric furling mast.
- Ample storage space.
- Fixed cutter stay.

Description

A robust, seaworthy centre cockpit yacht built by the prestigious Swedish yard Hallberg-Rassy on the boatbuilder's island of Orust. The Hallberg-Rassy 42F is a safe and reliable bluewater cruiser, perfectly suited for long-distance sailing with a small crew. Her deep centre cockpit, featuring a fixed windscreen and high coamings, offers excellent protection in challenging conditions, while wide running decks ensure safe and secure movement around the vessel underway. Designed by renowned Argentine naval architect Germán Frers and built to the high standards of Germanischer Lloyd (GL), this yacht combines performance, comfort, and quality. Generous fuel capacities provide impressive range, and ample storage throughout the yacht in lockers, drawers, and compartments adds to onboard convenience. The craftsmanship of Hallberg-Rassy shines through in every detail, from flawless fiberglass construction and exquisite joinery to the high-quality technical installations and fittings. Hallberg-Rassy 42F Mk II with reverse yacht transom and integrated swim platform. The yacht is offered by her second owner and comes with two-cabin layout and a timeless Scandinavian interior finished in satin-varnished Khaya mahogany. Indoor storage every winter and regular maintenance and service at a professional shipyard. Spacious and bright owner's cabin aft over the full beam of the yacht, offering twin berths, comfortable seating, and ample storage. The U-shaped galley is located to starboard in ...

Rig/Sails

- Deck-stepped, top-rigged Selden electric furling mast
- Two sets of spreaders
- RECKMANN furling genoa
- Fixed cutter stay with FURLEX 200s furling system (new 2021)
- Removable runners
- Spinnaker pole stowed on mast
- 2x LEWMAR 40.2CST halyard winches on mast
- Isolated backstay
- Aluminium tubes as protection for rigging screws
- Tri-color light and anchor light in masthead
- Furling mainsail Jan-Sails triradial approx. 39 m²
- Furling genoa Jan-Sails triradial approx. 46 m² with UV-protection
- Furling jib for cutter stay Jan-Sails triradial (new 2021) with UV-protection
- Gennaker HOOD-Sailmakers in snuffer
- Spinnaker/gennaker gear
- Stainless steel bow sprit for gennaker
- Canvas sleeve cover for furling genoa

Deck

- Teak deck on running decks, coachhouse roof, aft deck, swim platform and in cockpit
- LEWMAR 58.2CST genoa winches
- LEWMAR 40CEST electric maneuver winch to port
- LEWMAR 40.2CST mainsheet winches
- Electric anchor windlass LOFRANS Airon 1.000 W with remote control in cockpit
- Mooring gear: CQR-anchor 20 kg with 50 m anchor chain 9 mm and Wasi Powerball connector
- Fixed windscreen with aluminium frame and central opening window
- Sprayhood (new 2024)
- Cockpit cover
- Bimini
- Spacious cockpit locker to starboard
- Locker below aft deck
- Hot/cold cockpit shower
- Electric deck wash pump
- Swim ladder
- Bow ladder
- Spring cleats
- Teak seats integrated in aft pushpit
- Teak outboard bracket on pushpit
- Railing gates to port and starboard
- Folding teak cockpit table
- Aluminium and teak gangway

Layout/Interior

- Hallberg-Rassy 42F MK II in two-cabin layout with mahogany interior
- L-shaped dinette to port at folding saloon table
- Settee to starboard (converts to an additional berth by folding up backrest)
- Forward-facing chart table and navigator's seat to port aft
- U-shaped galley to starboard aft
 - Worktop in white Plexicor
 - Double sink
 - Additional fresh water foot pump
 - Electric cool box
 - Gas stove (2 burners and oven)
- Aft cabin with two single berths and settee, plenty of storage in cabinets and lockers, deck hatch and three coachroof windows
- Owner's heads compartment with separate shower, marine toilet and sink
- Forward cabin with V-berth, cabinets and lockers
- Second heads compartment to port forward with sink, marine toilet and shower
- Carpet throughout the boat (new 2023)
- Roller blinds in deck hatches
- Mosquito nets for portlights

Technical Equipment

- VOLVO PENTA TMD22 4-cylinder turbo diesel 76 hp/56 kW
- Two stainless steel diesel tanks approx. 200 l + 220 l
- Shaft drive with 3-blade MAXPROP folding propeller
- Spacious engine compartment with good access to technical components
- Dual switchable diesel filters
- Bow thruster Side Power 7 hp with foot control at helm
- 230 V shore power with charging cable
- 230 V sockets onboard
- Battery charger LEAB 12 V/50 A
- Inverter Victron 12 V/230 V/300 W
- 3 x service battery 12 V/140 Ah (total capacity: 12 V/420 Ah) new 2024
- Starter battery 12 V/100 Ah
- Alternator 12 V
- Additional 12 V alternator
- DCC4000 battery controller
- Two swiveling SOLARA solar panels aft on pushpit, port and starboard
- LED navigation lights
- WEBASTO AirTop 32s diesel heater
- Large gas locker below starboard side deck with two 6 kg aluminium gas bottles
- 2 x stainless steel holding tanks approx. 60 l each with deck connection and sea discharge
- 50 l hot water boiler
- Freshwater filter

Navigation/Electronics

- 4 x RAYMARINE i70 instrument display above companionway (new 2024)
- ROBERTSON Dataline X Waypoint+ Navdata display above companionway
- FURUNO radar system with radar antenna on mast
- AIS Class B transponder Weatherdock Easy TRX IS
- Autopilot ROBERTSON AP300X
- Compass
- Additional i70 display at chart table
- VHF-radio SHIPMATE RS8300
- Navtex receiver NAV4
- Shortwave receiver Lowe HF-150
- Radio/CD-player JVC with CD-changer and speakers in saloon and cockpit
- Clock, barometer, thermometer/hygrometer

Safety

- Life raft 4 pers. in container on sliding hatch garage
- Lifesling
- Marker buoy
- Jackstays on deck
- Electric horn
- Radar reflector
- Electric and manual bilge pumps
- Gas detector
- Rescue collar
- Life buoy
- Fire extinguisher

Accessories

- YAMAHA 2.5 hp 4-stroke outboard engine (new 2022 and never used)
- Cockpit cushions
- Covers for steering pedestal, winches and deck hatches
- Fenders
- Fender board
- Mooring lines
- Various inventory, spare parts and tools

Brokerage Liability Disclaimer

All information especially regarding the VAT-status of a yacht has been supplied by third parties. It is non-binding and without guarantee, subject to error and alteration. Our brokerage relies exclusively on information supplied by the vendor carefully compiled and checked by us to the best of our knowledge. Hence, a liability for correctness and completeness of provided information cannot be assumed.

IMAGES

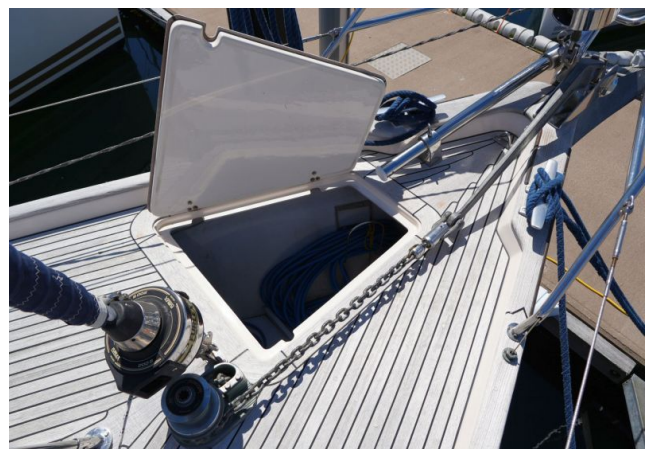

IMAGES

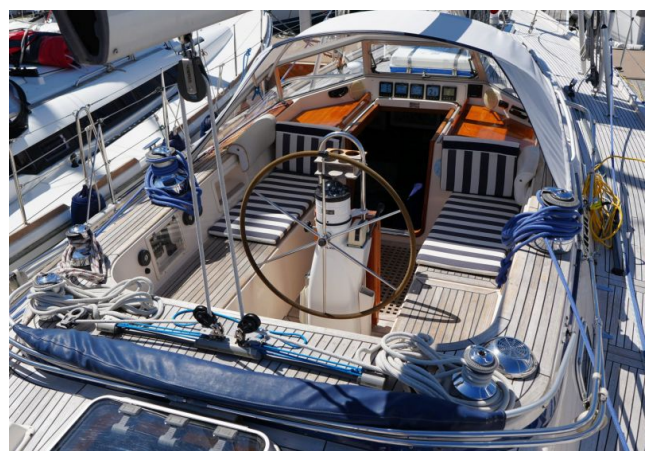
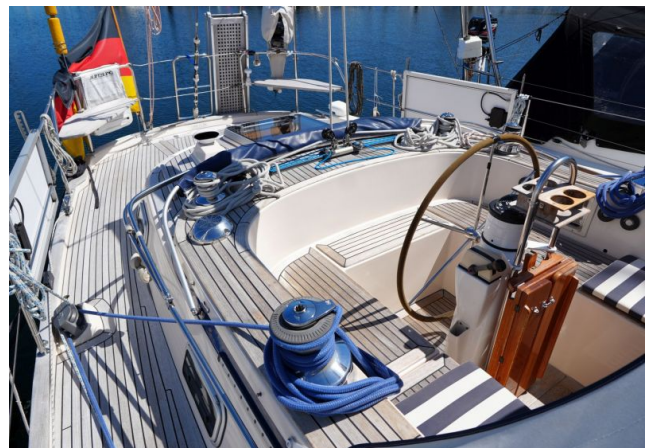

IMAGES

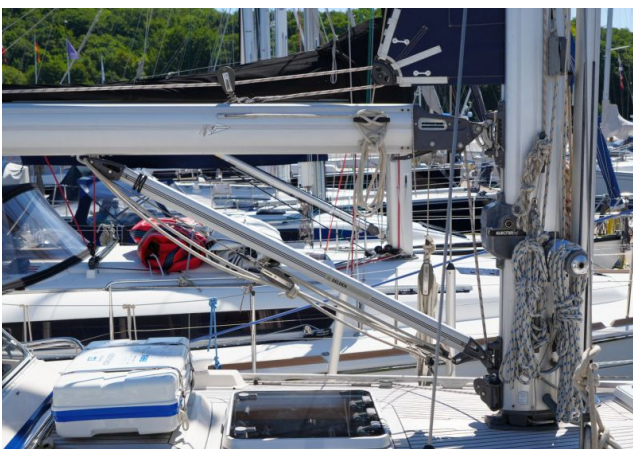
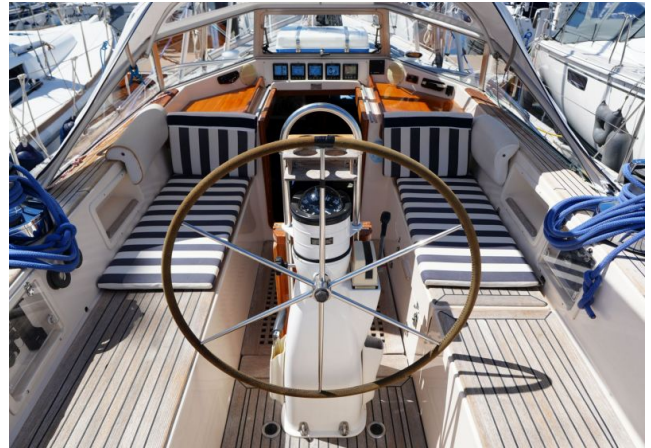

IMAGES

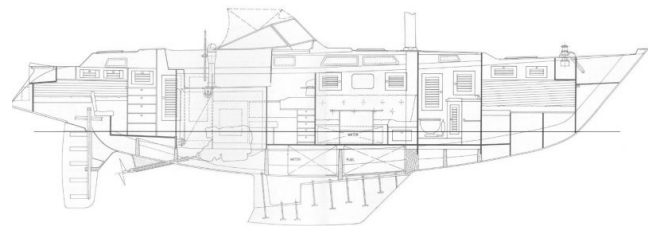
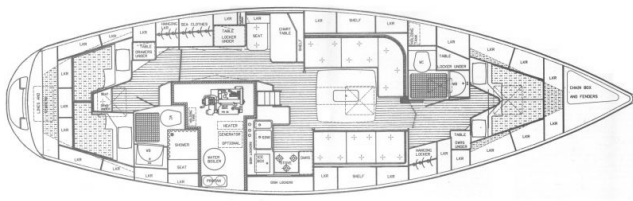

IMAGES



IMAGES



IMAGES



IMAGES

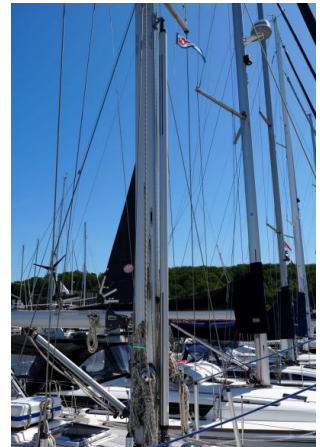

IMAGES

