



# HALLBERG-RASSY 372

Year 2012



DIAMOND

DIAMOND Yachts, Yachtzentrum Baltic Bay  
Börn 17 | 24235 Laboe

# HALLBERG-RASSY 372



## Main Info

<b>Model</b>	Hallberg-Rassy 372
<b>Manufacturer</b>	Hallberg-Rassy Varvs AB
<b>Designer</b>	Germán Frers
<b>Category</b>	Cruiser
<b>Year</b>	2012
<b>Location</b>	Deutsche Ostseeküste
<b>Flag</b>	Germany
<b>VAT status</b>	EU-VAT paid
<b>Material</b>	GRP
<b>Rig</b>	Sloop with furling mast
<b>Cabins</b>	2
<b>Berths</b>	4

## Dimensions & Material

<b>LOA</b>	11.35 m
<b>LWL</b>	10.25 m
<b>Beam</b>	3.60 m
<b>Draft</b>	1.99 m
<b>Displacement</b>	7.5 t
<b>Sail area</b>	73 m <sup>2</sup>
<b>Engine</b>	VOLVO PENTA D2-55
<b>Power</b>	55 PS/40 KW
<b>Drive</b>	Saildrive with folding propeller
<b>Fresh water</b>	470 L
<b>Fuel</b>	270 L
<b>Holding tank</b>	50 L

## Key Facts

- Solid Scandinavian construction.
- Excellent sailing performance.
- Complete FURUNO navigation.
- SELDEN furling mast.
- Hallberg-Rassy with aft cockpit.
- Electric winches.
- Inverter 2.500 W.
- Bow thruster.

## Description

Sturdy, seaworthy cruiser built by the Swedish quality yard Hallberg-Rassy on the boatbuilder's island of Orust. The Hallberg-Rassy 372 is a fast, stiff sailing yacht that is easy to steer and safe to sail in all conditions. The deep cockpit with fixed windshield and high coaming offers good protection and wide, unobstructed running decks allow safe movement even in rough conditions. Ample storage space throughout the yacht in lockers, drawers and compartments. The quality of boatbuilding craftsmanship at the traditional Hallberg-Rassy shipyard on the island of Orust in the Swedish western archipelago sets standards: the GRP workmanship, the interior finish and the quality of technical installations are immaculate. The Hallberg-Rassy 372 was voted "European Yacht of the Year 2010". This Hallberg-Rassy 372 is a well-maintained and extensively equipped yacht offered by her first owner. Indoor winter storage every year and continuous technical service. Complete specification incl. furling mast, bow thruster, inverter, electric winches, extensive FURUNO navigation system incl. radar and AIS, electric toilet etc. The Hallberg-Rassy 372 is moored on the German coast of the Baltic Sea, can be viewed any time upon appointment and is available for immediate delivery. The mooring can be transferred to the buyer.

## Rig/Sails

- Deck-stepped, 9/10-fractional SELDEN furling mast
- Three sets of aft-swept spreaders
- Headsail furling system FURLEX 300TD with drum below decks
- Fixed SELDEN kicker
- Spinnaker pole (stowed on mast)
- Trimmable, insulated backstay
- Aluminium protection for rigging screws
- LEWMAR 30ST EVO halyard winch on mast
- Wide mainsheet traveller in cockpit
- Genoa tracks with line-adjustable sheeting points
- 3-colour LED light and anchor light in mast top
- Furling mainsail ELVSTRÖM EPEX EMS approx. 41 m<sup>2</sup> with vertical battens
- Furling jib ELVSTRÖM EPEX EMS approx. 38 m<sup>2</sup> with vertical battens and UV-protection
- 2nd set of original standard sails furling main and furling jib ELVSTRÖM Dacron
- Gennaker ELVSTRÖM in snuffer
- Gennaker gear and stainless steel bowsprit

## Deck

- Teak deck on running decks, swim platform and in cockpit
- Electric genoa winches LEWMAR 50ST EVO
- LEWMAR 30ST EVO halyard winches
- LEWMAR electric windlass below decks with remote control in cockpit
- Mooring gear: DELTA-anchor 20 kg and 40 m anchor chain 8 mm
- Solid, laminated rubbing strake with stainless-steel profile on hull sides
- Central steering pedestal with stainless-steel steering wheel, console for instruments and stainless-steel console for chart plotter
- Fixed windscreen with aluminium frame, exterior grab rails and opening centre window
- Varnished chart tables and companionway
- Sprayhood
- Cockpit cover
- Large cockpit locker to starboard
- Two aft cockpit lockers
- Removable helm seat above passage to swim platform
- Electric deck wash pump
- Hot/cold stern shower
- Swim ladder
- Solid stainless-steel mooring cleats and spring cleats
- Stainless-steel chafing protection on mooring cleats
- Teak outboard engine bracket on pushpit
- Removable teak cockpit table
- Removable bow ladder

## Layout/Interior

- L-shaped sofa to port and longitudinal sofa to starboard at folding saloon table
- Forward-facing chart table and navigator's seat to starboard aft
- L-shaped galley to port aft
  - Worktop in white Plexicor
  - Double sink
  - Electric cool box
  - Gas stove (2 burners and oven)
  - Waste garbage bin
- Owner's cabin forward with V-shaped double berth, ample storage space in two lockers and storage compartments, large deck hatch and two coachhouse windows
- Aft cabin to port with double berth, locker, storage compartments, deck hatch, two portholes to cockpit and coach house window
- Heads compartment to starboard aft with sink, electric toilet and separable shower
- Carpet
- Exclusive, very well finished interior in satin-varnished Khaya mahogany
- New Laroma mattresses from 2018 in both cabins
- LED interior lighting

## Technical Equipment

- VOLVO PENTA D2-55 4-cylinder inboard diesel 55 hp/40 KW
- Engine hours (as of June 2024): 898 h
- Stainless-steel diesel tank approx. 270 l
- Saildrive with 3-blade folding propeller GORI
- Bow thruster SLEIPNER/Side Power with foot controls on cockpit floor
- 230 V shore power connection with charging cable
- 230 V sockets in the boat
- Combined battery charger and inverter MASTERVOLT Mass Combi 12 V/2.500 W/100 A
- 4 x service battery 6 V/195 Ah with a total capacity of 12 V/390 Ah (new 2024)
- Starter battery 12 V/75 Ah
- Alternator 12 V/115 A
- Solar panel on coach house roof
- LED navigation lights
- WEBASTO Airtop Evo 3900 diesel heater
- Hot water boiler 40 l
- Electric toilet (new 2018)
- Stainless-steel holding tank approx. 50 l with deck connection and sea discharge

## Navigation/Electronics

- Instruments above companionway:
  - 2 x FURUNO FI50 multi
  - FURUNO FI50 wind
- GPS/chart plotter FURUNO MFD8 NavNet 3D in stainless-steel console at helm station
- FURUNO radar antenna on mast (new 2018)
- GPS-receiver FURUNO GP-330B
- Compass
- FURUNO NavPilot 700 autopilot
- VHF-radio FURUNO FM-2721 DSC at charttable
- AIS Class B-transponder FURUNO FA-50
- Interface for FURUNO network at chart table
- Radio/CD-player with speakers in saloon and cockpit
- WEMPE clock, barometer, thermometer/hygrometer

## Safety

- 6-person life raft in quick drop bracket on pushpit
- Electric and manual bilge pump
- Lifesling
- Fire extinguisher

## Accessories

- Furling jib cover
- Canvas cover for steering pedestal
- Dinghy with outboard engine
- Fenders
- Mooring lines

### Brokerage Liability Disclaimer

All information especially regarding the VAT-status of a yacht has been supplied by third parties. It is non-binding and without guarantee, subject to error and alteration. Our brokerage relies exclusively on information supplied by the vendor carefully compiled and checked by us to the best of our knowledge. Hence, a liability for correctness and completeness of provided information cannot be assumed.



## IMAGES





## IMAGES





## IMAGES





## IMAGES





## IMAGES





## IMAGES



## IMAGES

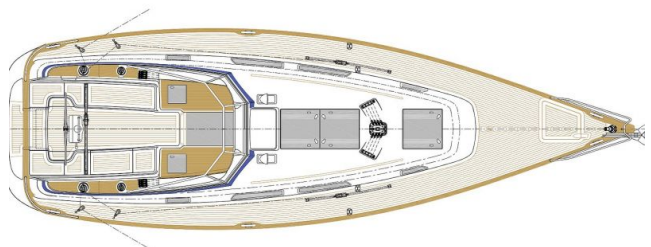
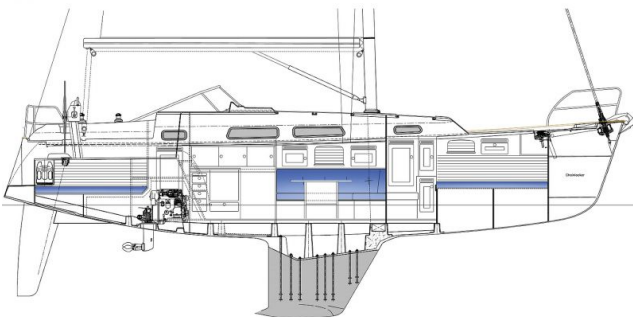
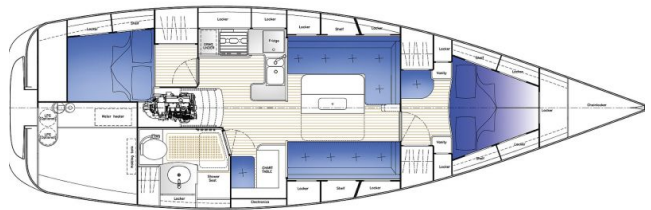



## IMAGES

